

**BOUTON CRUCIFORME EN FONTE GRISE  
- DIN 6335**

H.24620



**MATIERE ET EXECUTION :**

Fonte grise GG 20, finement sablée.

**Forme A** = pièce brute. **Forme B** = avec trou lisse traversant.

**Forme C** = avec trou borgne.

**Forme D** = avec trou taraudé et chambre traversante.

**Forme E** = avec trou taraudé.

d1	Ø d2	Ø d4 H7	d5	Ø d6	h1	h2	h3	t1	t2	t4	poids (g)
32	12	6	M6	6,4	21	20	10	15	12	10	38
40	14	8	M8	8,4	26	25	14	18	15	12	69
50	18	10	M10	10,5	34	32	20	21	18	16	115
63	20	12	M12	13	42	40	25	25	22	20	228
80	25	16	M16	17	52	50	30	32	28	30	415
100	32	20	M20	21	65	63	38	40	36	38	855

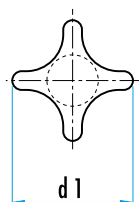

d1	FORME A	FORME B	FORME C	FORME D	FORME E
32	H.24620.0032	H.24620.0132	H.24620.0232	H.24620.0332	H.24620.0432
40	H.24620.0040	H.24620.0140	H.24620.0240	H.24620.0340	H.24620.0440
50	H.24620.0050	H.24620.0150	H.24620.0250	H.24620.0350	H.24620.0450
63	H.24620.0063	H.24620.0163	H.24620.0263	H.24620.0363	H.24620.0463
80	H.24620.0080	H.24620.0180	H.24620.0280	H.24620.0380	H.24620.0480
100	H.24620.0090	H.24620.0190	H.24620.0290	H.24620.0390	H.24620.0490

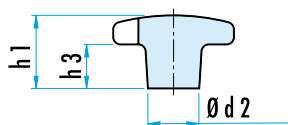

**A**

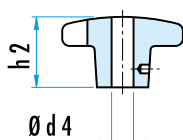

**B**

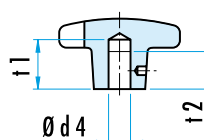

**C**

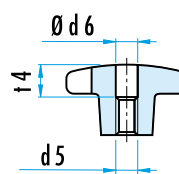

**D**

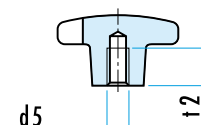

**E**

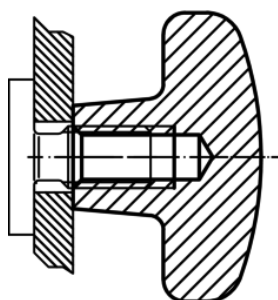

**BOUTON CRUCIFORME EN FONTE  
PLASTIFIEE - DIN 6335**

H.24620



**MATIERE ET EXECUTION :**  
Fonte grise GG 20, plastifiée orange ou noir.  
Forme C = avec trou borgne.  
Forme E = avec trou taraudé.

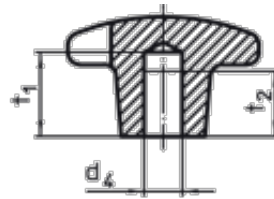

**C**

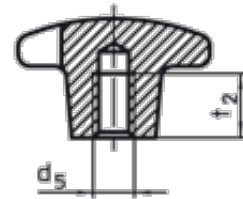

**E**

d1	d2	d4h7	d5	h1	t1	t2	poids (g)	Ref. forme C		Ref. forme E	
								orange	noir	orange	noir
40	14	8	M8	25	18	15	62	H.24620.0540	H.24620.0640	H.24620.0541	H.24620.0641
50	18	10	M10	32	21	18	106	H.24620.0550	H.24620.0650	H.24620.0551	H.24620.0651
63	20	12	M12	40	25	22	201	H.24620.0563	H.24620.0663	H.24620.0564	H.24620.0664
80	25	16	M16	50	32	28	353	H.24620.0580	H.24620.0680	H.24620.0581	H.24620.0681

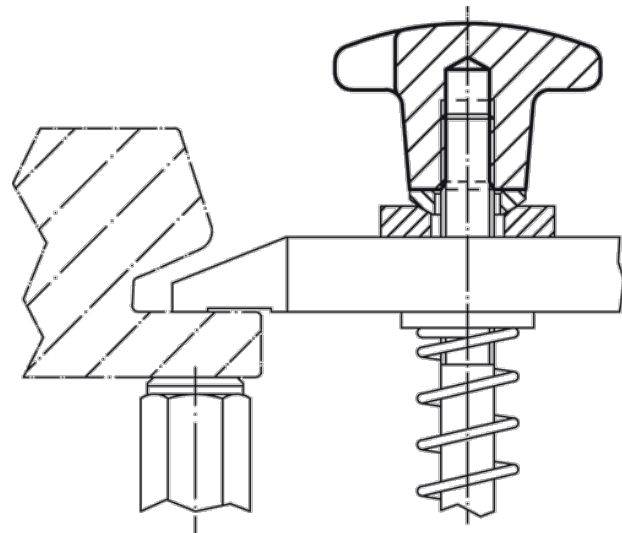

**BOUTON CRUCIFORME EN ALUMINIUM  
- DIN 6335**

H.24630



**MATIERE ET EXECUTION :**

Aluminium brut ou poli

Forme A = pièce brute

Forme B = avec trou lisse traversant.

Forme C = avec trou borgne.

Forme D = avec trou taraudé et chambre traversante.

Forme E = avec trou taraudé.



d1	Ø d2	Ø d4 H7	d5	Ø d6	h1	h2	h3	t1	t2	t4	poids (g)
40	14	8	M8	8,4	26	25	14	18	15	12	69
50	18	10	M10	10,5	34	32	20	21	18	16	115
63	20	12	M12	13	42	40	25	25	22	20	228
80	25	16	M16	17	52	50	30	32	28	30	415

**ALU BRUT :**

d1	FORME A	FORME B	FORME C	FORME D	FORME E
40	H.24630.0040	H.24630.0140	H.24630.0240	H.24630.0340	H.24630.0440
50	H.24630.0050	H.24630.0150	H.24630.0250	H.24630.0350	H.24630.0450
63	H.24630.0063	H.24630.0163	H.24630.0263	H.24630.0363	H.24630.0463
80	H.24630.0080	H.24630.0180	H.24630.0280	H.24630.0380	H.24630.0480

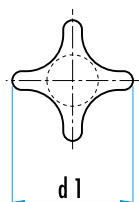

**ALU POLI :**

d1	FORME A	FORME B	FORME C	FORME D	FORME E
40	-	H.24630.0540	H.24630.0640	H.24630.0740	H.24630.0840
50	-	H.24630.0550	H.24630.0650	H.24630.0750	H.24630.0850
63	-	H.24630.0563	H.24630.0663	H.24630.0763	H.24630.0863
80	-	H.24630.0580	H.24630.0680	H.24630.0780	H.24630.0880

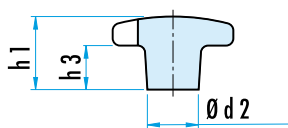

**A**

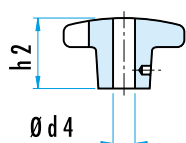

**B**

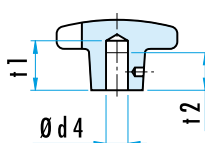

**C**

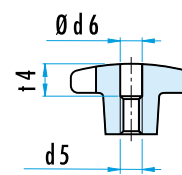

**D**

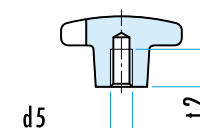

**E**

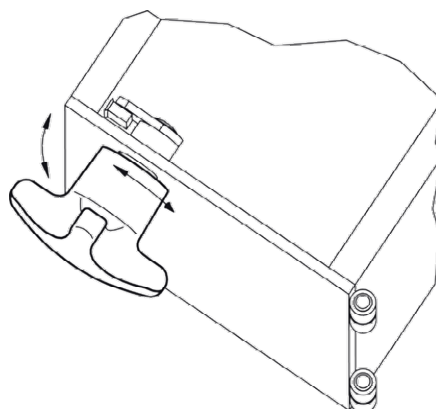

**BOUTON CRUCIFORME MASSIF EN INOX - DIN 6335**

D6335

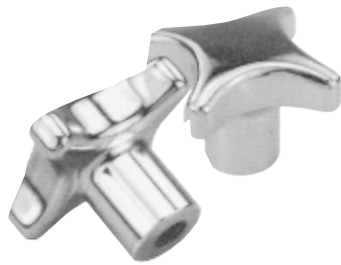

**MATIERE ET EXECUTION :** INOX 1.4308, rectifié et poli.

forme B = avec trou traversant

forme C = avec trou borgne

forme D = avec taraudage et trou traversant

forme E = avec taraudage

Sur demande : avec filet extérieur.



Ø D1	Ø D2	Ø D4 <sup>H7</sup>	D5	Ø D6	H1	H2	H3	T1	T2	T3
32	12	6	M6	6,4	21	20	10	15	12	10
40	14	8	M8	8,4	26	25	13	18	15	12
50	18	10	M10	10,5	34	32	17	21	18	16
63	20	12	M12	13	42	40	21	25	22	20

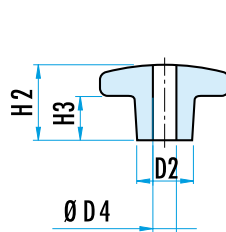
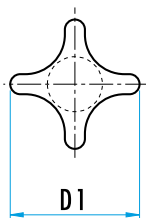

**B**

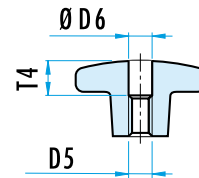

**D**

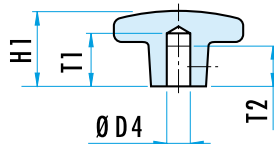

**C**

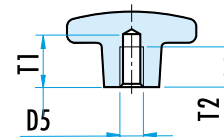

**E**

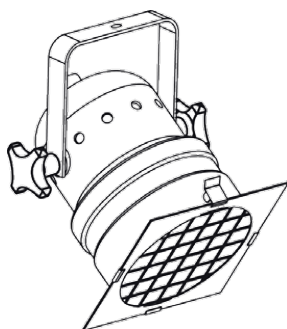

Ø D1	Ref.			
	FORME B	FORME C	FORME D	FORME E
32	D6335B.RF.32	D6335C.RF.32	D6335D.RF.32	D6335E.RF.32
40	D6335B.RF.40	D6335C.RF.40	D6335D.RF.40	D6335E.RF.40
50	D6335B.RF.50	D6335C.RF.50	D6335D.RF.50	D6335E.RF.50
63	D6335B.RF.63	D6335C.RF.63	D6335D.RF.63	D6335E.RF.63