

PIECES DE RECHANGE ET D'USURE POUR MACHINES D'EROSION A FIL

EDM.WAC.SM



- Pour les machines à fil suivantes : AGIE - CHARMILLES - FANUC - HITACHI - JAPAX - MAKINO - MITSUBISHI - SEIBU - SODICK - BROTHER.
- Pour les perceuses rapides suivantes : AGIE - ASTEC - CHARMILLES - COBRA B - JAPAX - SEIBU - SODICK.

Veuillez nous communiquer la marque et le type de votre machine.

Dès réception nous vous enverrons une liste des pièces de rechange (contacts électriques, guide-fil, buses d'enfilage, couteaux, galets de pression, etc...)

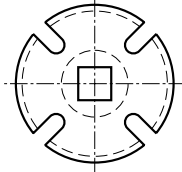
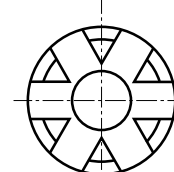
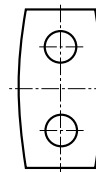
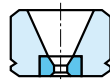
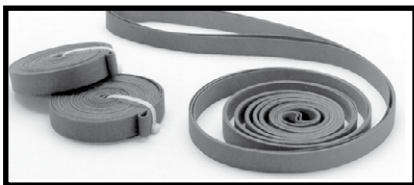
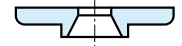
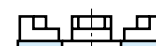
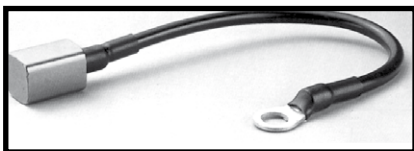
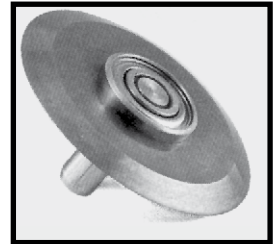
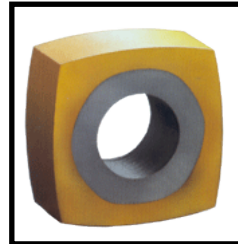
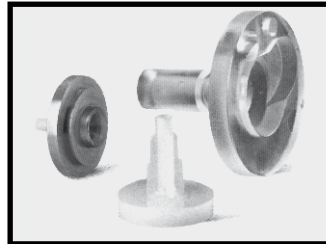
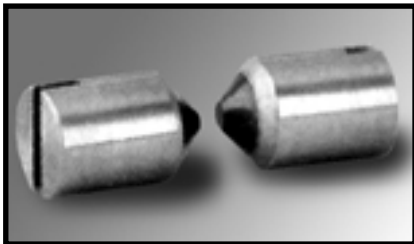

GUIDE-FIL

CONTACT ELECTRIQUE

SAPHIR

COUPE-FIL