

**KRUISKNOP UIT GRIJS GIETIJZER
DIN 6335**

H.24620



MATERIAAL EN UITVOERING :

Grijs gietijzer GG 20, fijn gezandstraald.

Vorm A = ruw stuk.

Vorm B = met doorlopende boring.

Vorm C = met blinde boring.

Vorm D = met getapte boring en doorgeboorde kamer.

d1	Ø d2	Ø d4 H7	d5	Ø d6	h1	h2	h3	t1	t2	t4	Gewicht (g)
32	12	6	M6	6,4	21	20	10	15	12	10	38
40	14	8	M8	8,4	26	25	14	18	15	12	69
50	18	10	M10	10,5	34	32	20	21	18	16	115
63	20	12	M12	13	42	40	25	25	22	20	228
80	25	16	M16	17	52	50	30	32	28	30	415
100	32	20	M20	21	65	63	38	40	36	38	855

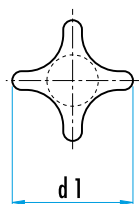

d1	VORM A	VORM B	VORM C	VORM D	VORM E
32	H.24620.0032	H.24620.0132	H.24620.0232	H.24620.0332	H.24620.0432
40	H.24620.0040	H.24620.0140	H.24620.0240	H.24620.0340	H.24620.0440
50	H.24620.0050	H.24620.0150	H.24620.0250	H.24620.0350	H.24620.0450
63	H.24620.0063	H.24620.0163	H.24620.0263	H.24620.0363	H.24620.0463
80	H.24620.0080	H.24620.0180	H.24620.0280	H.24620.0380	H.24620.0480
100	H.24620.0090	H.24620.0190	H.24620.0290	H.24620.0390	H.24620.0490

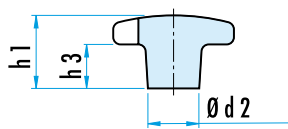

A

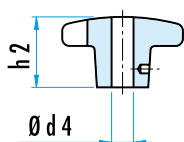

B

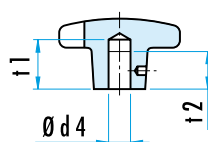

C

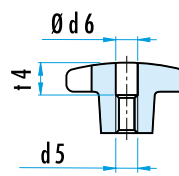

D

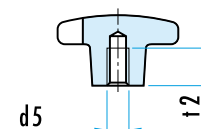

E

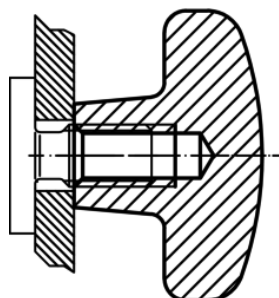

KRUISKNOP UIT GIETIJZER MET KUNSTSTOFFEN BEKLEDING - DIN 6335

H.24620



MATERIAAL EN UITVOERING :

Grijs gietijzer, GG20, met **oranje of zwarte** kunststoffen bekleding.

Vorm C = met blinde boring.

Vorm E = met binnenschroefdraad.

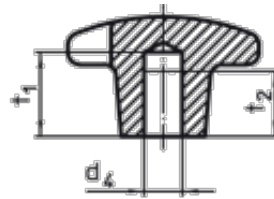

C

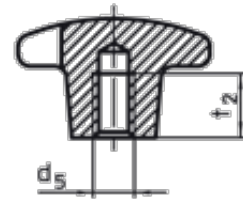

E

d1	d2	d4h7	d5	h1	t1	t2	Gewicht (g)	Ref. VORM C		Ref. VORM E	
								oranje	zwart	oranje	zwart
40	14	8	M8	25	18	15	62	H.24620.0540	H.24620.0640	H.24620.0541	H.24620.0641
50	18	10	M10	32	21	18	106	H.24620.0550	H.24620.0650	H.24620.0551	H.24620.0651
63	20	12	M12	40	25	22	201	H.24620.0563	H.24620.0663	H.24620.0564	H.24620.0664
80	25	16	M16	50	32	28	353	H.24620.0580	H.24620.0680	H.24620.0581	H.24620.0681

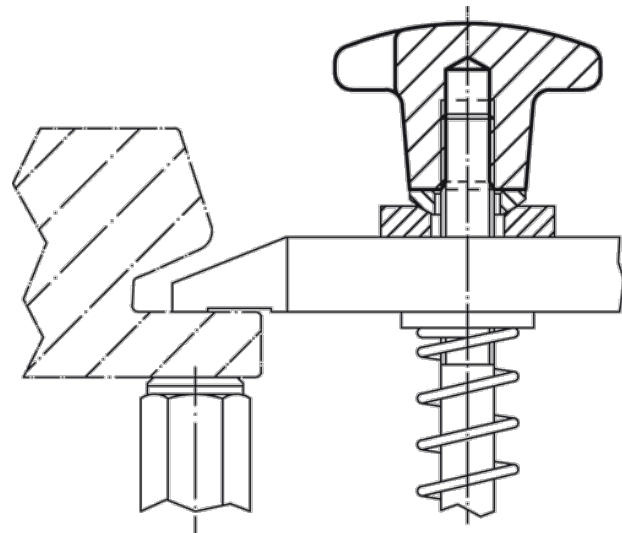

**KRUISKNOP UIT ALUMINIUM
- DIN 6335**

H.24630



MATERIAAL EN UITVOERING :

Aluminium, **ruw** of **gepolijst**.

Vorm A = ruw stuk.

Vorm B = met doorlopende boring.

Vorm C = met blinde boring.

Vorm D = met getapte boring en doorgeboorde kamer.

Vorm E = met binnenschroefdraad.



d1	Ø d2	Ø d4 H7	d5	Ø d6	h1	h2	h3	t1	t2	t4	Gewicht (g)
40	14	8	M8	8,4	26	25	14	18	15	12	69
50	18	10	M10	10,5	34	32	20	21	18	16	115
63	20	12	M12	13	42	40	25	25	22	20	228
80	25	16	M16	17	52	50	30	32	28	30	415

ALU RUW :

d1	VORM A	VORM B	VORM C	VORM D	VORM E
40	H.24630.0040	H.24630.0140	H.24630.0240	H.24630.0340	H.24630.0440
50	H.24630.0050	H.24630.0150	H.24630.0250	H.24630.0350	H.24630.0450
63	H.24630.0063	H.24630.0163	H.24630.0263	H.24630.0363	H.24630.0463
80	H.24630.0080	H.24630.0180	H.24630.0280	H.24630.0380	H.24630.0480

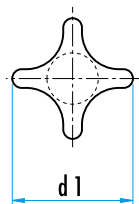

ALU GEPOLIJST :

d1	VORM A	VORM B	VORM C	VORM D	VORM E
40	-	H.24630.0540	H.24630.0640	H.24630.0740	H.24630.0840
50	-	H.24630.0550	H.24630.0650	H.24630.0750	H.24630.0850
63	-	H.24630.0563	H.24630.0663	H.24630.0763	H.24630.0863
80	-	H.24630.0580	H.24630.0680	H.24630.0780	H.24630.0880

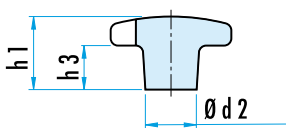

A

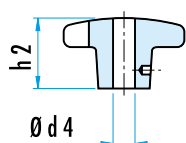

B

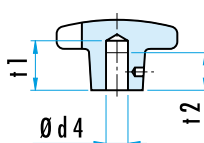

C

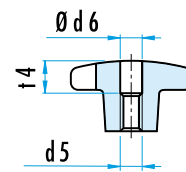

D

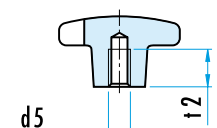

E

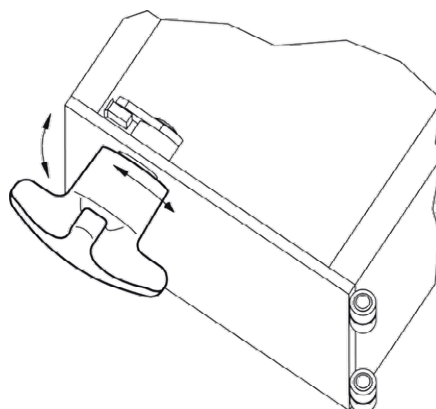

VOLLE KRUISKNOP UIT RVS - DIN 6335

D6335

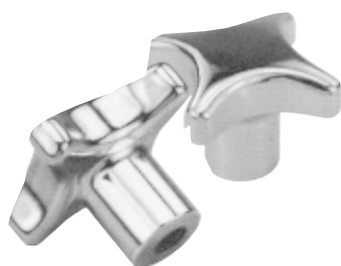

MATERIAAL EN UITVOERING : RVS 1.4308, geslepen en gepolijst.

vorm B = met doorlopende boring

vorm C = met blinde boring

vorm D = met getapte boring en doorlopende kamer

vorm E = met getapte boring

op aanvraag : met buitenschroefdraad.



Ø D1	Ø D2	Ø D4 ^{H7}	D5	Ø D6	H1	H2	H3	T1	T2	T3
32	12	6	M6	6,4	21	20	10	15	12	10
40	14	8	M8	8,4	26	25	13	18	15	12
50	18	10	M10	10,5	34	32	17	21	18	16
63	20	12	M12	13	42	40	21	25	22	20

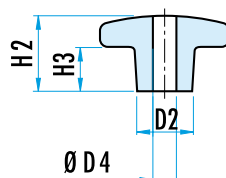
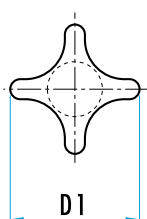

B

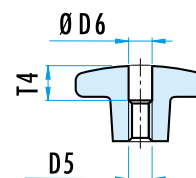

D

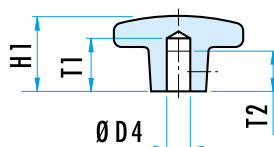

C

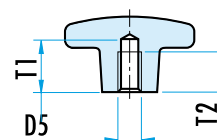

E

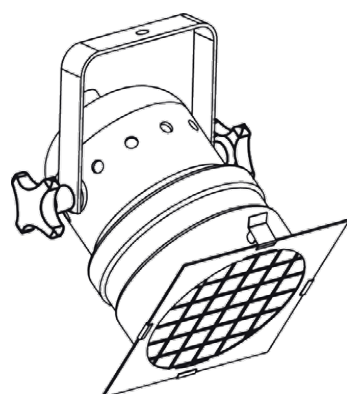

Ø D1	Ref.			
	VORM B	VORM C	VORM D	VORM E
32	D6335B.RF.32	D6335C.RF.32	D6335D.RF.32	D6335E.RF.32
40	D6335B.RF.40	D6335C.RF.40	D6335D.RF.40	D6335E.RF.40
50	D6335B.RF.50	D6335C.RF.50	D6335D.RF.50	D6335E.RF.50
63	D6335B.RF.63	D6335C.RF.63	D6335D.RF.63	D6335E.RF.63