

KRUISKNOP UIT DUROPLAST DIN 6335K

D6335K

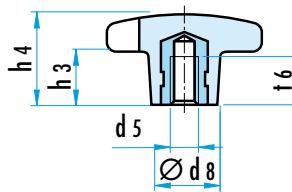

MATERIAAL : zwarte duroplast, glanzend oppervlak.
UITVOERING : met metalen inzetstuk,

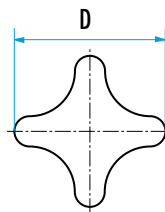

| D | d5 | Ø d8 | h3 | h4 | t6 | Ref. |
|----|-----|------|----|----|-----|-----------|
| 20 | M4 | 10 | 6 | 13 | 6,5 | D6335K.20 |
| 25 | M5 | 12 | 8 | 16 | 9,5 | D6335K.25 |
| 32 | M6 | 14 | 10 | 20 | 12 | D6335K.32 |
| 40 | M8 | 18 | 13 | 25 | 14 | D6335K.40 |
| 50 | M10 | 22 | 20 | 32 | 18 | D6335K.50 |
| 63 | M12 | 26 | 25 | 40 | 22 | D6335K.63 |
| 80 | M16 | 35 | 30 | 50 | 30 | D6335K.80 |

KRUISKNOP UIT DUROPLAST MET DRAADSTANG - DIN 6335 A

D6335A



MATERIAAL EN UITVOERING : zwarte duroplast, glanzend oppervlak, draadstang uit verzinkt staal.

Knopafmetingen volgens DIN 6335 (zie hierboven).

Op aanvraag : andere draadstanglengte, draadstang uit messing of RVS.

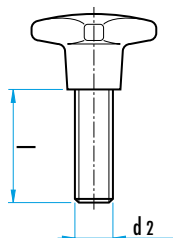
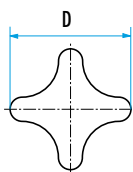

| Ø d1 | d2 | l | Ref. |
|------|----|----|--------------|
| 25 | M5 | 10 | D6335A.25.10 |
| | | 15 | D6335A.25.15 |
| | | 20 | D6335A.25.20 |
| | | 25 | D6335A.25.25 |
| | | 30 | D6335A.25.30 |
| 32 | M6 | 15 | D6335A.32.15 |
| | | 20 | D6335A.32.20 |
| | | 25 | D6335A.32.25 |
| | | 30 | D6335A.32.30 |
| | | 40 | D6335A.32.40 |
| 40 | M8 | 20 | D6335A.40.20 |
| | | 25 | D6335A.40.25 |
| | | 30 | D6335A.40.30 |
| | | 40 | D6335A.40.40 |
| | | 50 | D6335A.40.50 |

| Ø d1 | d2 | l | Ref. |
|------|-----|----|--------------|
| 50 | M10 | 25 | D6335A.50.25 |
| | | 30 | D6335A.50.30 |
| | | 40 | D6335A.50.40 |
| | | 50 | D6335A.50.50 |
| | | 60 | D6335A.50.60 |
| 63 | M12 | 30 | D6335A.63.30 |
| | | 40 | D6335A.63.40 |
| | | 50 | D6335A.63.50 |
| | | 60 | D6335A.63.60 |
| | | 80 | D6335A.63.80 |
| 80 | M16 | 40 | D6335A.80.40 |
| | | 50 | D6335A.80.50 |
| | | 60 | D6335A.80.60 |
| | | 80 | D6335A.80.80 |

KRUISKNOP DIN 6335 UIT DUROPLAST MET RVS SCHROEF

H.24640



MATERIAAL :

Knop uit zwarte Duroplast PF 31.
Bus uit RVS.1.4301 (AISI 304).

OPMERKING :

Max. temperatuur : 110°C.
Zie andere maten op blz. 2.

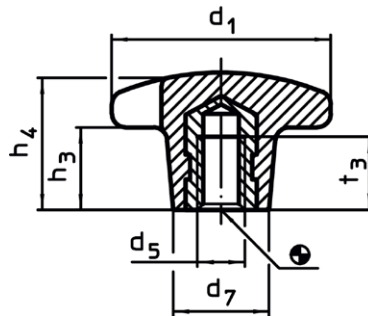

| Ø d1 | d5 | Ø d7 | h3 | h4 | t3 | Ref. |
|------|------|------|----|----|-----|--------------|
| 25 | M 5 | 12 | 8 | 16 | 9,5 | H.24640.1225 |
| 32 | M 6 | 14 | 10 | 20 | 12 | H.24640.1232 |
| 40 | M 8 | 18 | 13 | 25 | 14 | H.24640.1240 |
| 50 | M10 | 22 | 20 | 32 | 18 | H.24640.1250 |
| 63 | M12 | 26 | 25 | 40 | 22 | H.24640.1263 |
| 80 | M 16 | 35 | 30 | 50 | 30 | H.24640.1280 |

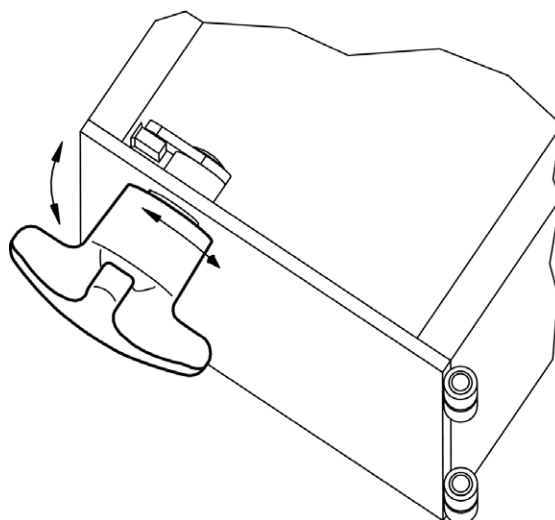

KRUISKNOP DIN 6335 UIT DUROPLAST MET RVS SCHROEF

H.24730

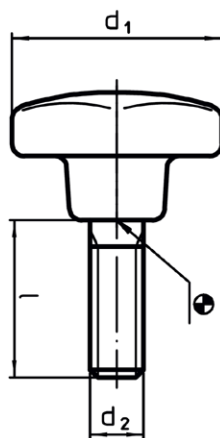

MATERIAAL :

Knop uit zwarte Duroplast PF 31.
Schroef uit RVS.1.4301 (AISI 304).

OPMERKING :

Max. temperatuur : 110°C.

| d1 | d2 | l | Ref. |
|----|-----|----|--------------|
| 25 | M 5 | 10 | H.24730.1051 |
| 25 | M 5 | 15 | H.24730.1053 |
| 25 | M 5 | 20 | H.24730.1056 |
| 25 | M 5 | 25 | H.24730.1058 |
| 25 | M 5 | 30 | H.24730.1059 |
| 32 | M 6 | 15 | H.24730.1101 |
| 32 | M 6 | 20 | H.24730.1104 |
| 32 | M 6 | 25 | H.24730.1106 |
| 32 | M 6 | 30 | H.24730.1107 |
| 32 | M 6 | 40 | H.24730.1110 |
| 40 | M 8 | 20 | H.24730.1152 |
| 40 | M 8 | 25 | H.24730.1154 |
| 40 | M 8 | 30 | H.24730.1155 |
| 40 | M 8 | 40 | H.24730.1158 |
| 40 | M 8 | 50 | H.24730.1160 |
| 50 | M10 | 25 | H.24730.1202 |
| 50 | M10 | 30 | H.24730.1203 |
| 50 | M10 | 40 | H.24730.1206 |
| 50 | M10 | 50 | H.24730.1208 |
| 50 | M10 | 60 | H.24730.1209 |
| 63 | M12 | 30 | H.24730.1251 |
| 63 | M12 | 40 | H.24730.1254 |
| 63 | M12 | 50 | H.24730.1256 |
| 63 | M12 | 60 | H.24730.1257 |
| 63 | M12 | 80 | H.24730.1260 |
| 80 | M16 | 40 | H.24730.1302 |
| 80 | M16 | 50 | H.24730.1304 |
| 80 | M16 | 60 | H.24730.1305 |
| 80 | M16 | 80 | H.24730.1308 |

KRUISKNOP UIT DUROPLAST OF THERMOPLAST DIN 6335 MET UITSTEKENDE BUS UIT STAAL

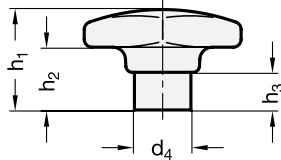
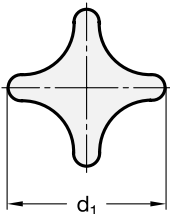
GWN.6335.1 / 2

MATERIAAL EN UITVOERING :

 Ref. GWN.6335.1... : uit duroplast (PF), zwart, glanzend,
 met bus uit verzinkt staal, blauw gechromeed.

 Ref. GWN.6335.2... : uit thermoplast (PA) schokbestendig, zwart, mat,
 met bus uit verzinkt staal, blauw gechromeed.

Vorm E = met binnenschroefdraad..

Vorm C = met boring H7.

OPMERKING :

 De uitstekende bus laat toe :
 een perfecte vlak stalen oppervlak.
 Een bevestiging door stift.

| d1 | d4 | h1 | ≈ h2 | h3 | t min. |
|----|----|----|------|----|--------|
| 32 | 12 | 20 | 10 | 9 | 12 |
| 40 | 14 | 25 | 13 | 10 | 14 |
| 50 | 18 | 32 | 20 | 12 | 18 |
| 63 | 20 | 40 | 25 | 14 | 22 |
| 80 | 25 | 50 | 30 | 17 | 30 |

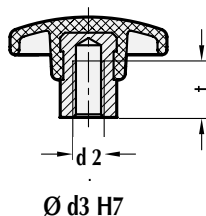
 Ref. GWN.6335.1
 DUROPLAST

DUROPLAST Vorm E

| d1 | d2 | Ref. |
|----|------|--------------------|
| 32 | M 6 | GWN.6335.1.32.06.E |
| 40 | M 8 | GWN.6335.1.40.08.E |
| 50 | M 10 | GWN.6335.1.50.10.E |
| 63 | M 12 | GWN.6335.1.63.12.E |
| 80 | M 16 | GWN.6335.1.80.16.E |

DUROPLAST Vorm C

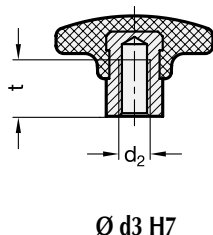
| d1 | Ø d3 | Ref. |
|----|------|--------------------|
| 32 | 6 | GWN.6335.1.32.06.C |
| 40 | 6 | GWN.6335.1.40.06.C |
| 40 | 8 | GWN.6335.1.40.08.C |
| 50 | 8 | GWN.6335.1.50.08.C |
| 50 | 10 | GWN.6335.1.50.10.C |
| 63 | 10 | GWN.6335.1.63.10.C |
| 63 | 12 | GWN.6335.1.63.12.C |
| 80 | 16 | GWN.6335.1.80.16.C |

 Ref. GWN.6335.2
 THERMOPLAST

THERMOPLAST Vorm E

| d1 | d2 | Ref. |
|----|------|--------------------|
| 32 | M 6 | GWN.6335.2.32.06.E |
| 40 | M 6 | GWN.6335.2.40.06.E |
| 40 | M 8 | GWN.6335.2.40.08.E |
| 50 | M 8 | GWN.6335.2.50.08.E |
| 50 | M 10 | GWN.6335.2.50.10.E |
| 63 | M 10 | GWN.6335.2.63.10.E |
| 63 | M 12 | GWN.6335.2.63.12.E |
| 80 | M 12 | GWN.6335.2.80.12.E |
| 80 | M 16 | GWN.6335.2.80.16.E |

THERMOPLAST Vorm C

| d1 | Ø d3 | Ref. |
|----|------|--------------------|
| 32 | 6 | GWN.6335.2.32.06.C |
| 40 | 6 | GWN.6335.2.40.06.C |
| 40 | 8 | GWN.6335.2.40.08.C |
| 50 | 8 | GWN.6335.2.50.08.C |
| 50 | 10 | GWN.6335.2.50.10.C |
| 63 | 10 | GWN.6335.2.63.10.C |
| 63 | 12 | GWN.6335.2.63.12.C |
| 80 | 16 | GWN.6335.2.80.16.C |

KRUISKNOP DIN 6335 UIT THERMOPLAST MET UITSTEKENDE BUS UIT RVS

GWN.6335.2



MATERIAAL EN UITVOERING :

Ref. GWN.6335.2... : uit thermoplast (PA) schokbestendig, zwart, mat.
met bus uit RVS 1.4305.

Vorm ER = met binnenschroefdraad..

OPMERKING :

De uitstekende bus laat toe :

- een perfecte vlak RVS oppervlak.
- een bevestiging door stift.

| d1 | d2 | d3 | h1 | ≈ h2 | h3 | t min. | Ref. |
|----|------|----|----|------|----|--------|------------------|
| 32 | M 6 | 12 | 20 | 10 | 9 | 12 | GWN.6335.2.32.ER |
| 40 | M 8 | 14 | 25 | 13 | 10 | 14 | GWN.6335.2.40.ER |
| 50 | M 10 | 18 | 32 | 20 | 12 | 18 | GWN.6335.2.50.ER |
| 63 | M 12 | 20 | 40 | 25 | 14 | 22 | GWN.6335.2.63.ER |

